

20.80

40.9

39.30

5.10+/-0.30

$\varnothing 8.20+/-0.1$

0.90

3.0

7.30

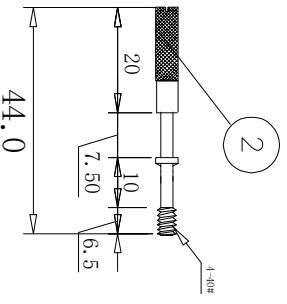

10.50+/-0.30

0.45+/-0.10

5.9

R1.5

R5

R1.5

7.3

26.10

33

0.60±0.05

磁线OD范围: 3.0~8.0mm

16.00±0.3

6.00

#4-40

5.30+/-0.2

2.30+/-0.1

11.00

$\varnothing 3.00+/-0.30$

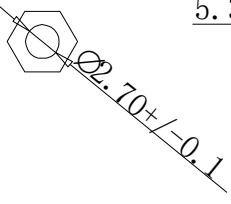

PART NO.:

B05-015NN8N9-XXB

ENTRY HOLE SIZE:

- 60: OD=6.0MM
- 70: OD=7.0MM
- 90: OD=9.0MM

ITEM	DESC.	MATERIAL	REMARKS	PART REMAKS
6	线夹	STEEL	PLATING: Ni	2PCS
5	#4*12.5mm螺杆	STEEL	PLATING: Ni	2PCS
4	固定螺母	STEEL	PLATING: Ni	2PCS
3	方形垫片	STEEL	PLATING: Ni	2PCS
2	螺丝#4-40 UNC	STEEL	PLATING: Ni	2PCS
1	上下外壳	ZINC	PLATING: SEE NOTE	1SET

QUALITY SYMBOLS

□: MAJOR

△: CRITICAL

▽: ZERO DEFECT

NAME: D-SUB 15P 合金外壳AMP 长螺丝

REV: A

SCALE: N:1

DATE: 2018/08/08

DRW BY: KING ZHOU

CHK BY: KING ZHOU

APP BY: KING ZHOU

DRAWING NO. 505A-001

东莞市箐国电子有限公司

A	DATE	DESCRIPTION	APPROVER
8	2018/08/08	新版发行	King Zhou

B	QUALITY SYMBOLS	CRITICAL	MAJOR	ZERO DEFECT	S.P.C
7	□: <input type="checkbox"/>	△: <input type="checkbox"/>	▽: <input type="checkbox"/>		

C	Tolerance	X: ±0.50	X: ±0.30	.xx: ±0.15
4				

D	NAME:	D-SUB 15P 合金外壳AMP 长螺丝
E	REV:	A
F	SCALE:	N:1
	DATE:	2018/08/08
	DRW BY:	KING ZHOU
	CHK BY:	KING ZHOU
	APP BY:	KING ZHOU
	DRAWING NO.:	505A-001