

NOTES:

• ELECTRICAL CHARACTERISTICS

Contact Current Rating: 1 Amp
 Dielectric Withstanding Voltage: 500V AC
 Insulation Resistance: 500MΩ/Min
 Contact Resistance: 35mΩ/Max
 Operation Temperature: -55°C ~ +105°C

PART NO: B02-03611E0-X0

WIRE HOLDER:
 28AWG or 30AWG WIRE
 6 = 0.62mm
 7 = 0.75mm
 9 = 0.90mm

4	COVER	PBT+30%G.F. (UL 94V-0)	COLOR: BLACK
3	HOUSING	PBT+30%G.F. (UL 94V-0)	COLOR: BLACK
2	SHELL	SPCC (t=0.50mm)	Ni Plating
1	TERMINAL	PHOSPHOR BRONZE(t=0.25mm)	CONTACT AREA: Au G/F SOLDER AREA: Sn 100U" UNDER-PLATING: Ni 50U"

QUALITY SYMBOLS

□: MAJOR

△: CRITICAL

▽: ZERO DEFECT

▽: S.P.C

NAME:	SCSI-II 36P MALE IDC TYPE
REV:	A
UNIT:	mm
SCALE:	N:1
DATE:	2017/01/14
DRW BY:	DAWN HU
CHK BY:	KING ZHOU
APP BY:	
DRAWING NO.:	AL3-011

ITEM	DESC.	MATERIAL	REMARKS	PART REMARKS
1	TERMINAL	PHOSPHOR BRONZE(t=0.25mm)		

Tolerance	◎0.50
	◎0.30
	±0.25

DATE:	2017/01/14
APPROVER:	King Zhou

DESCRIPTION:	King Zhou
DATE:	2017/01/14

DESCRIPTION:	King Zhou
DATE:	2017/01/14

东莞市箐国电子有限公司

- FEATURES:**
- Round cable straight exit
 - Strain Relief Staple With Spring Latches
 - Back shell desing by Die-Cast
 - Excellent EMI/RFI protection

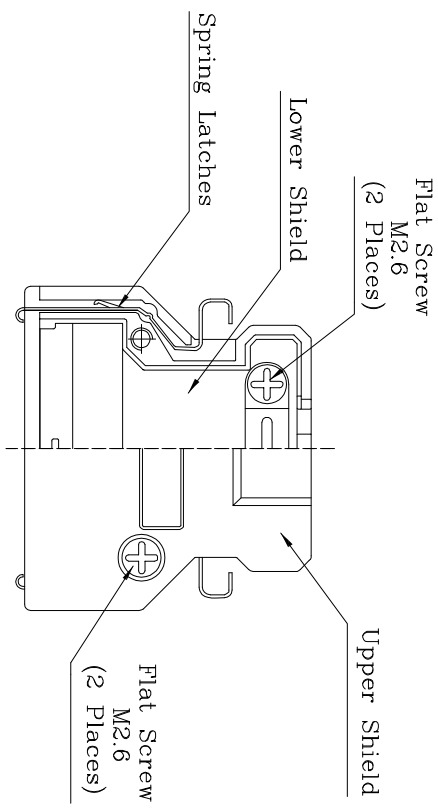
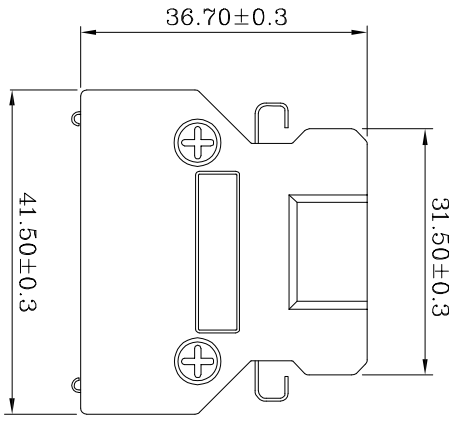
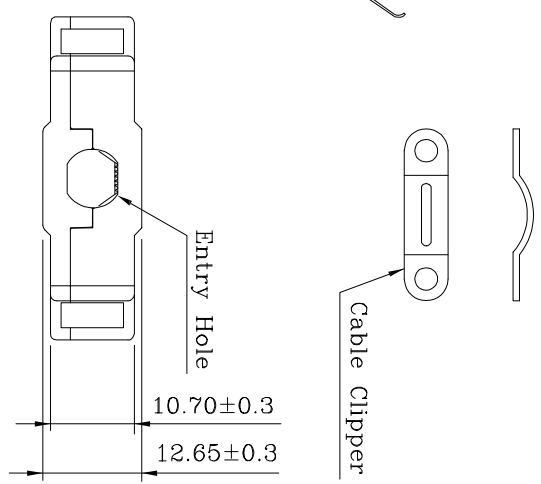
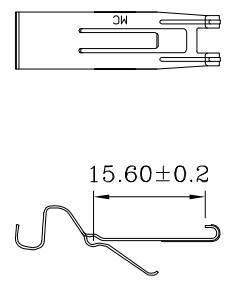
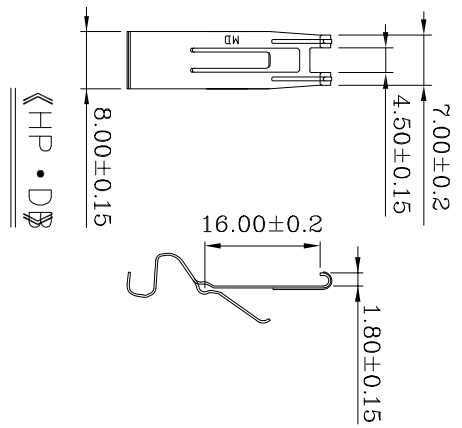

PART NO: BXX-036NN8N3-XX
 SPECIFICATION: 02:HPDB
 03:HPCN
 ENTRY HOLE SIZES: 70 = 7.5mm
 90 = 9.0mm

4	Clipper	Steel	Ni Plating	
3	Screw	Steel	Ni Plating	
2	Spring latch	Stainless Steel	Ni Plating	
1	Back Shell	ZINC	Ni Plating	

QUALITY SYMBOLS

CRITICAL MAJOR

ZERO DEFECT S.P.C

NAME: SCS1 36P ZINC Metal Hood With Latch PART NO. BXX-036NN8N3-XX

REV: A UNIT: mm DRW BY CHK BY APP BY DRAWING NO. BXX-036

SCALE: N:1 DATE: 2022/01/14 DAWN HU KING ZHOU

东莞市箐国电子有限公司

A	DATE	DESCRIPTION	APPROVER
8	2022/01/14新版发行	King Zhou	

B	DATE	DESCRIPTION	APPROVER
7			

C	DATE	DESCRIPTION	APPROVER
6			

D	DATE	DESCRIPTION	APPROVER
5			

E	DATE	DESCRIPTION	APPROVER
4			

F	DATE	DESCRIPTION	APPROVER
3			

F	DATE	DESCRIPTION	APPROVER
2			

F	DATE	DESCRIPTION	APPROVER
1			