

8 7 6 5 4 3 2 1

• MATERIALS:(RoHS Compliant)

Housing And Cover : Plastic thermoplastic
P.B.T UL94V-0 black
Contacts : Phosphor bronze gold
selective plated
Front Shell : Steel nickel plated
over copper

• ELECTRICAL CHARACTERISTICS

Contact Current Rating: 1 Amp
Contact Withstanding Voltage: 500V AC
Insulation Resistance: 500MΩ/Min
Contact Resistance: 35mΩ/Max
Operation Temperature: -55°C ~ +105°C

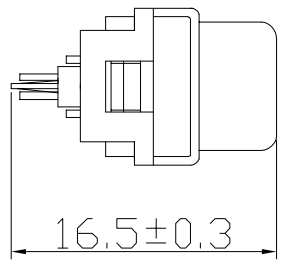
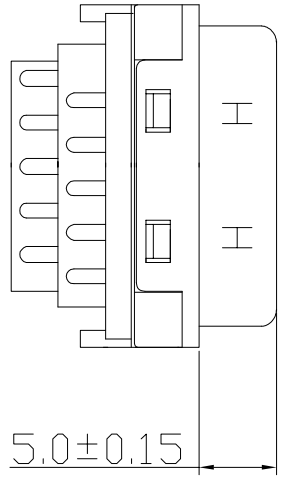
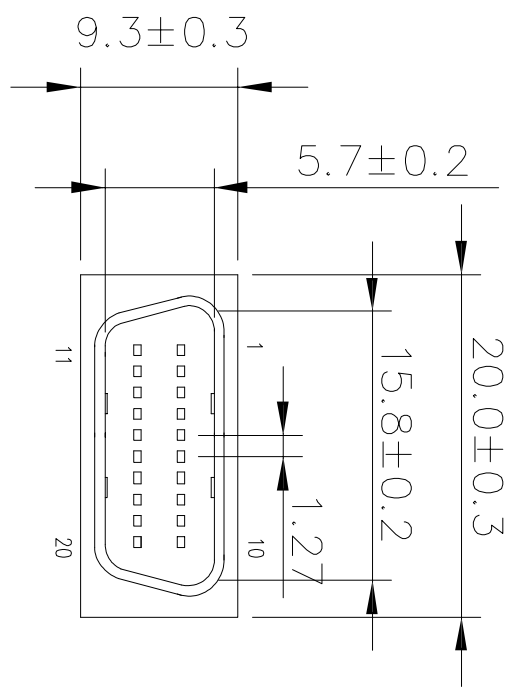

A		B		C		D		E		F					
△		EQ02-020311E0-011		QUALITY SYMBOLS		Tolerance		NAME:		PART NO.					
△				□ :	☒ :	X.	±0.50	REV:	A	UNIT:	mm	DRW BY	CHK BY	APP BY	DRAWING NO.
△	2015/07/16	新版发行	King Zhou	CRITICAL	MAJOR	X.	±0.30	SCALE:	N:1	DATE:	2015/07/16	DAW NHU	KING ZHOU		MDD-005
SIDE	DATE	DESCRIPTION	APPROVER	ZERO DEFECT	S.P.C	⊙	±0.15	东莞市箐国电子有限公司							
8		7	6	5	4	3	2								

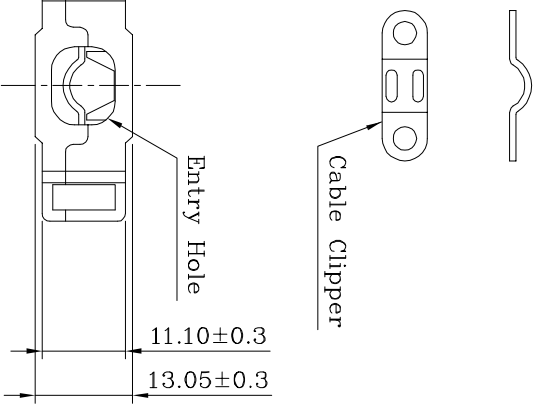
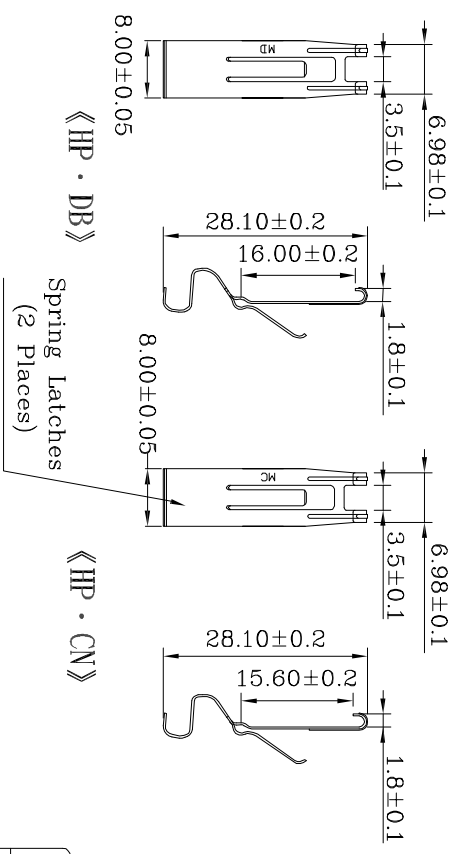

- FEATURES:**
- Round cable straight exit
 - Strain Relief Staple With Spring Latches
 - Back shell desing by Die-Cast
 - Excellent EMI/RFI protection

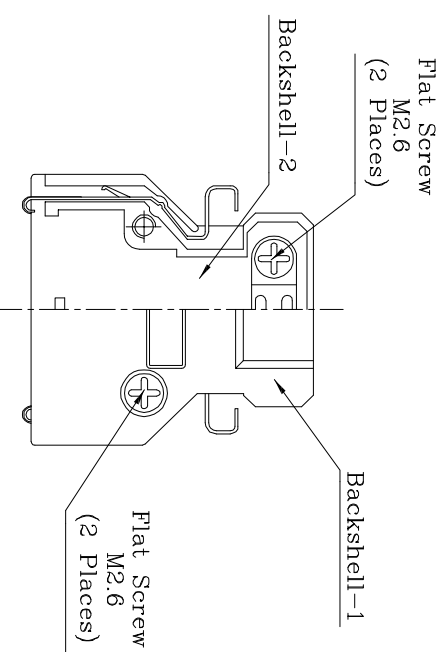
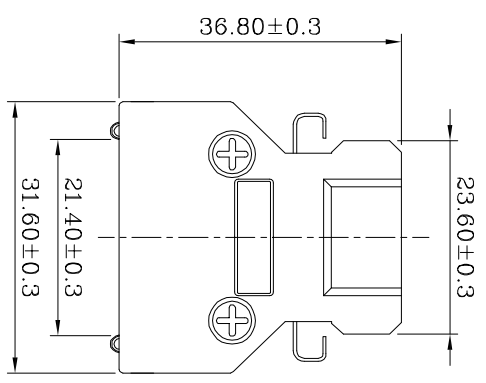

PART NO: BXX-020NN8N3-XX

SPECIFICATION: 02:HPDB
03:HPCN

ENTRY HOLE SIZES: 70= 7.0mm
80= 8.0mm

4	Clipper	Steel	Ni Plating	
3	Screw	Steel	Ni Plating	
2	Spring latch	Stainless Steel	Ni Plating	
1	Back Shell	ZINC	Ni Plating	

QUALITY SYMBOLS	<input type="checkbox"/> : Tolerance <input checked="" type="checkbox"/> : CRITICAL <input type="checkbox"/> : MAJOR <input type="checkbox"/> : ZERO DEFECT <input type="checkbox"/> : S.P.C
NAME:	SCSI 20P ZINC Metal Hood With Latch
REV:	A
UNIT:	mm
SCALE:	N:1
DATE:	2022/01/14
DRW BY:	DAWN HU
CHK BY:	KING ZHOU
PART NO.:	BXX-020NN8N3-XX
APP BY:	
DRAWING NO.:	BXX-036

DATE	2022/01/14新版发行	APPROVER	King Zhou
DESCRIPTION	DESCRPTION		
SIDE	8	7	6

东莞市箐国电子有限公司