

8 7 6 5 4 3 2 1

• MATERIALS:(RoHS Compliant)

Housing And Cover : Plastic thermoplastic
P.B.T UL94V-0 black
Contacts : Phosphor bronze gold
selective plated
Front Shell : Steel nickel plated
over copper

• ELECTRICAL CHARACTERISTICS

Contact Current Rating: 1 Amp
Contact Withstanding Voltage: 500V AC
Insulation Resistance: 500MΩ/Min
Contact Resistance: 35mΩ/Max
Operation Temperature: -55°C ~ +105°C

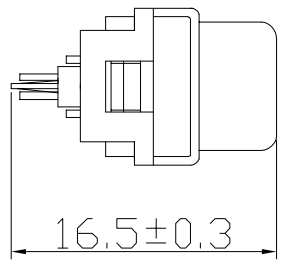
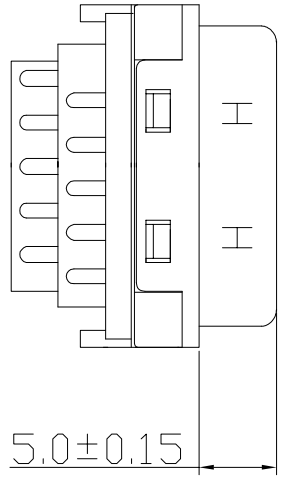
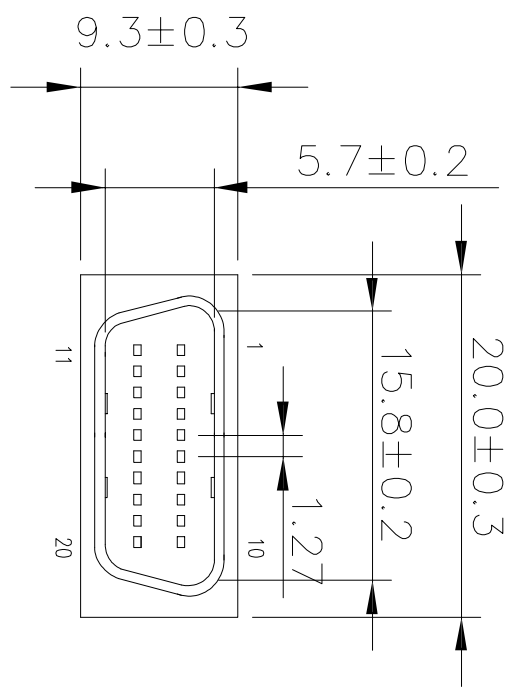

A		B		C		D		E		F					
△		EQ02-020311E0-011		QUALITY SYMBOLS		Tolerance		NAME:		PART NO.					
△				□ :	☒ :	X.	±0.50	REV:	A	UNIT:	mm	DRW BY	CHK BY	APP BY	DRAWING NO.
△	2015/07/16	新版发行	King Zhou	CRITICAL	MAJOR	X.	±0.30	SCALE:	N:1	DATE:	2015/07/16	DAW NHU	KING ZHOU		MDD-005
△				ZERO DEFECT	S.P.C	.xx	±0.15	<p style="text-align: center;">东莞市箐国电子有限公司</p>							
SIDE	DATE	DESCRIPTION	APPROVER												
8		7		6		5		4		3		2		1	

- FEATURES:**
- Plastic hood with Jackscrews
 - Steel inner shell
 - Full EMI/RFI shielded

MATERIALS:

- Hood: Plastic ABS
- Inner Shell: Steel , Nickel plated
- Jackscrews: Steel Nickel Plated Over Copper.
- Jackscrews Hood:PVC(30P)
- RoHS compliant

Ordering Information

MPS 20P K 6 3

ENTRY HOLE SIZES:

- 6 = $\phi 6.0$
- 6A = $\phi 6.5$
- 7 = $\phi 7.0$
- 7A = $\phi 7.5$

CONTACT FINISHES:

- 1 = #2-56
- 2 = #4-40
- 3 = M2.6

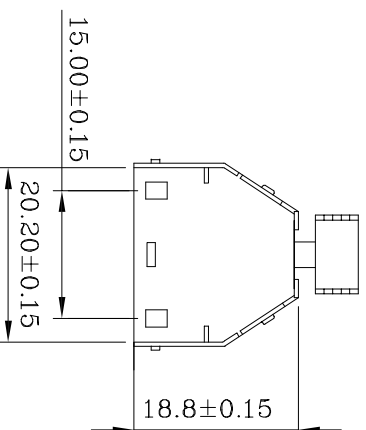
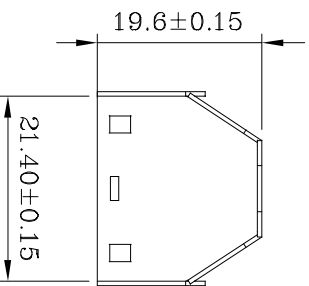
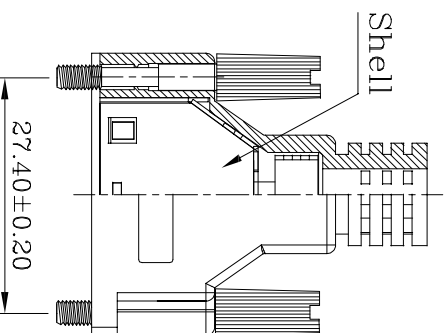
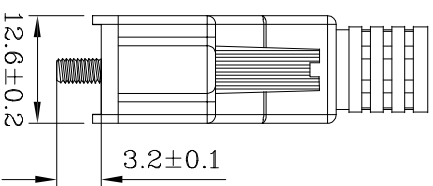
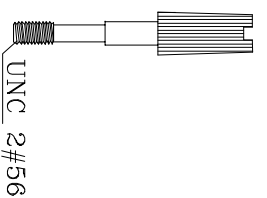
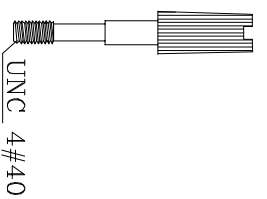
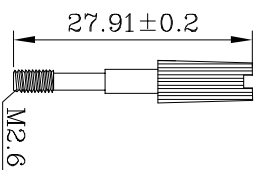
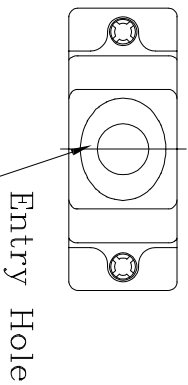
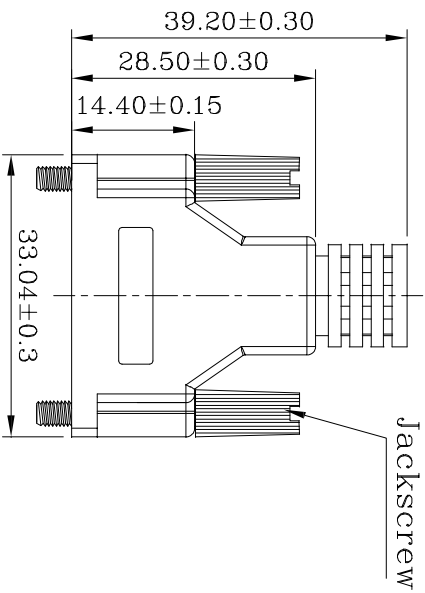

QUALITY SYMBOLS		Tolerance		NAME: SCS1 20P ABS Hood With Screw		PART NO. MPS20PKXX	
<input type="checkbox"/>	CRITICAL	x	±0.50	REV: B	UNIT: mm	DRW BY: DAW NHU	CHK BY: KING ZHOU
<input type="checkbox"/>	MAJOR	x	±0.30	SCALE: NONE	DATE: 2019/02/20		
<input type="checkbox"/>	S.P.C	.xx	±0.10				
APPROVER: JANE ZHEN		DRAWING NO.		东莞市箐园电子有限公司			
DESCRIPTION: 图面发行		DRAWING NO.					
DATE: 2019-7-20		DRAWING NO.					
SIDE		DATE					