

NOTES:

• ELECTRICAL CHARACTERISTICS

- Contact Current Rating: 1 Amp
- Dielectric Withstanding Voltage: 500V AC
- Insulation Resistance: 500MΩ/Min
- Contact Resistance: 35mΩ/Max
- Operation Temperature: -55°C ~ +105°C

4	COVER	PBT+30%G.F. (UL 94V-0)	COLOR: BLACK	
3	HOUSING	PBT+30%G.F. (UL 94V-0)	COLOR: BLACK	
2	SHELL	SPCC (t=0.50mm)	Ni Plating	
1	TERMINAL	PHOSPHOR BRONZE(t=0.25mm)	CONTACT AREA: Au 5u" SOLDER AREA: Sn 100u" UNDER-PLATING: Ni 50u"	

QUALITY SYMBOLS

- : CRITICAL
- ⊠ : MAJOR
- ∇ : ZERO DEFECT
- S.P.C

Tolerance		NAME:	SCSI 20P Male Solder Type		PART NO.:	B03-020311E3-01	
x .	∅0.50	REV:	A	UNIT:	mm	DRW BY:	CHK BY:
x	∅0.30	SCALE:	N:1	DATE:	2021/01/14	DAWN HU	KING ZHOU
.xx	±0.25						

Tolerance		NAME:	SCSI 20P Male Solder Type		PART NO.:	B03-020311E3-01	
x .	∅0.50	REV:	A	UNIT:	mm	DRW BY:	CHK BY:
x	∅0.30	SCALE:	N:1	DATE:	2021/01/14	DAWN HU	KING ZHOU
.xx	±0.25						

东莞市箐园电子有限公司

DATE	2021/01/14	新板发行
APPROVER	King Zhou	

DESCRIPTION		
SIDE	8	

8 7 6 5 4 3 2 1

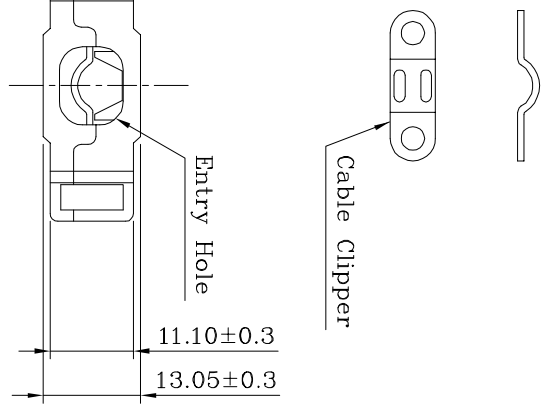
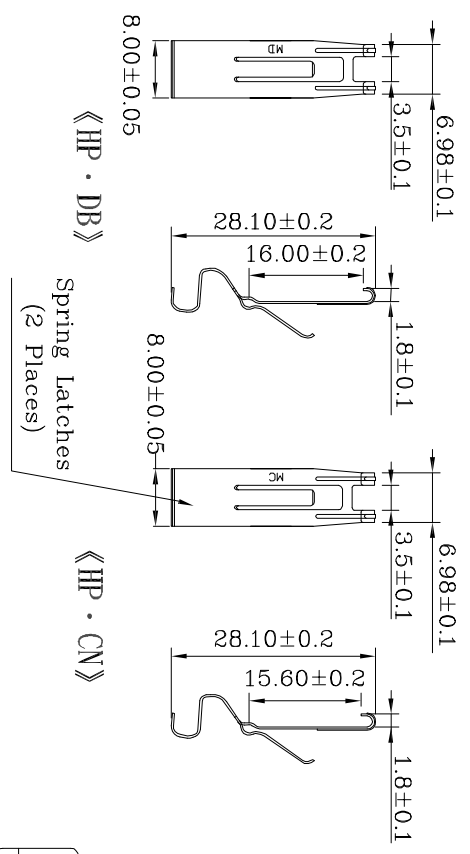

- FEATURES:**
- Round cable straight exit
  - Strain Relief Staple With Spring Latches
  - Back shell desing by Die-Cast
  - Excellent EMI/RFI protection

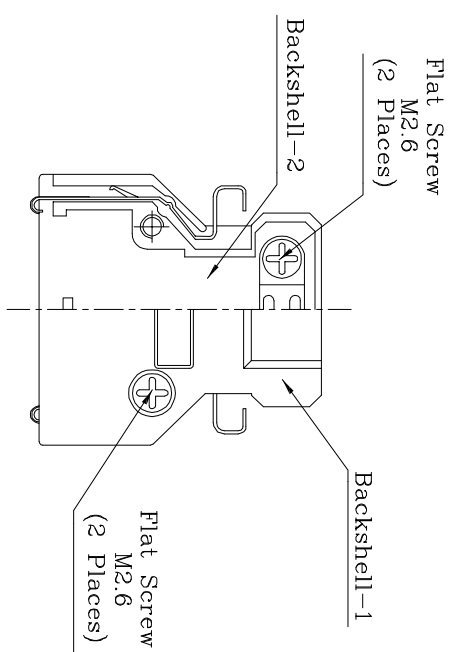
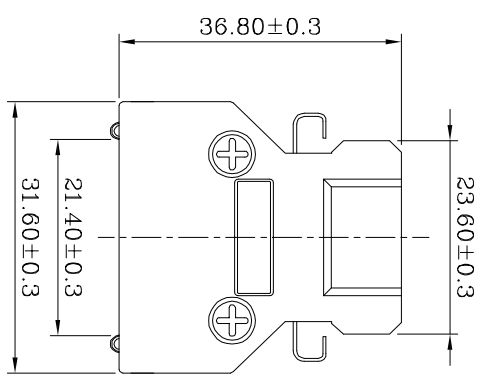

PART NO: BXX-020NN8N3-XX  
 SPECIFICATION: 02:HPDB 03:HPCN  
 ENTRY HOLE SIZES: 70= 7.0mm 80= 8.0mm

4	Clipper	Steel	Ni Plating	
3	Screw	Steel	Ni Plating	
2	Spring latch	Stainless Steel	Ni Plating	
1	Back Shell	ZINC	Ni Plating	

QUALITY SYMBOLS	<input type="checkbox"/> : <input checked="" type="checkbox"/> : CRITICAL MAJOR ZERO DEFECT S.P.C.
Tolerance	NAME: SCS1 20P ZINC Metal Hood With Latch REV: A UNIT: mm SCALE: N:1 DATE: 2022/01/14 DAWN HU KING ZHOU

QUALITY SYMBOLS	<input type="checkbox"/> : <input checked="" type="checkbox"/> : CRITICAL MAJOR ZERO DEFECT S.P.C.
NAME:	SCS1 20P ZINC Metal Hood With Latch
REV:	A
UNIT:	mm
SCALE:	N:1
DATE:	2022/01/14
DRW BY:	DAWN HU
CHK BY:	KING ZHOU
PART NO.:	BXX-020NN8N3-XX
APP BY:	
DRAWING NO.:	BXX-036

DATE	2022/01/14新版发行
APPROVER	King Zhou

8 7 6 5 4 3 2 1

东莞市箐国电子有限公司