

• ELECTRICAL CHARACTERISTICS

Contact Current Rating: 1 Amp
 Dielectric Withstanding Voltage: 500V AC
 Insulation Resistance: 500MΩ/Min
 Contact Resistance: 35mΩ/Max
 Operation Temperature: -55°C ~ +105°C

ITEM	DESC.	MATERIAL	REMARKS	PART REMARKS
4	COVER	PBT+G.F.30% (UL 94V-0)	COLOR:BLACK	
3	HOUSING	PBT+G.F.30% (UL 94V-0)	COLOR:BLACK	
2	SHELL	SPCC	PLATING:NI	
1	TERMINAL	C5191	CONTACT AREA: Au 5u" SOLDER AREA: Sn 100u" UNDER-PLATING: Ni 50u"	

QUALITY SYMBOLS

□ : MAJOR
 ⊠ : CRITICAL

▽ : ZERO DEFECT

Tolerance	NAME:	SCST 28P MALE SOLDER ASSEMBLY TYPE (客户用图)	PART NO.	PART REMARKS
±0.50	REV: G	UNIT: mm	DAWN HU	B03-026311E0-01
±0.30	SCALE: N:1	DATE: 2021/07/05	KING ZHOU	B03-026
±0.15				

DATE	DESCRIPTION	APPROVER
2021/07/05	新版发行	DAWN HU

REV:	UNIT:	DATE:	SCALE:	DATE:	SCALE:
G	mm	2021/07/05	N:1	2021/07/05	N:1

东莞市箐国电子有限公司

• MATERIALS:(RoHS Compliant)

Hood: Plastic Thermoplastic ABS UL 94V-0
 Jackscrews: Steel Nickel Plated Over Copper
 Jackscrews Hood: PVC
 Inner Shell: Steel Nickel Plated Over Copper

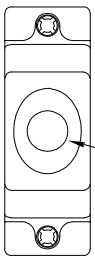

Entry Hole

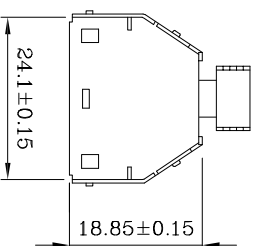
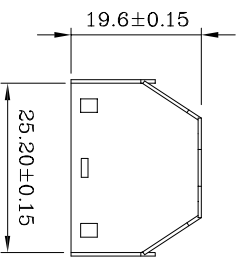
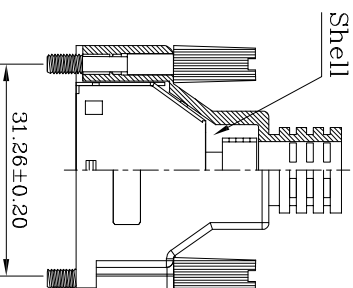
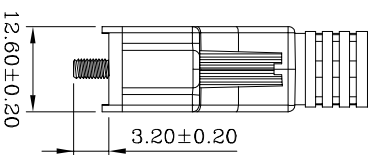
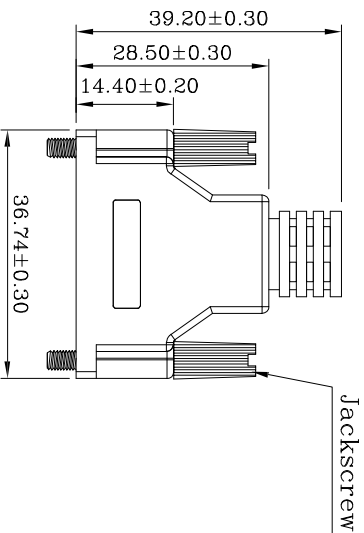
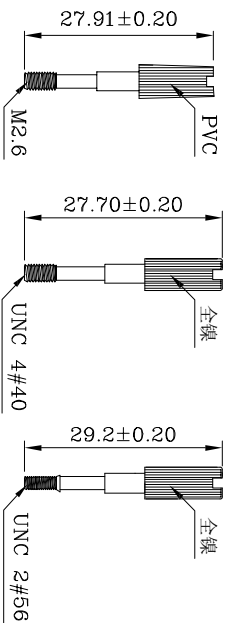

CONTACT TYPES: _____
 26Pos Straight Exit (Hood Type)
 HOOD COLORS: _____
 K= Black
 ES= Especial
 ENTRY HOLE SIZES: _____
 7= $\phi 7.0$
 8= $\phi 8.0$
 8A= $\phi 8.5$
 CONTACT FINISHES: _____
 1= #2-56
 2= #4-40
 3= M2.6

MPS 26 K 8 3

△			
△	2017-2-20	根据实物修改公差	JANE ZHEN
△	2009-7-20	图面发行	JANE ZHEN
SIDE	DATE	DESCRIPTION	APPROVER
8	7	6	5

QUALITY SYMBOLS		Tolerance	
□ :	CRITICAL	X :	±0.50
⊠ :	MAJOR	.x :	±0.30
▽ :	ZERO DEFECT	.xx :	±0.10
S.P.C			

NAME:	SCSI 26P ABS Hood With Screw			PART NO.	MPS26PXXX
REV.:	B	UNIT:	mm	CHK BY	KING ZHOU
SCALE:	NONE	DATE:	2017/02/20	APP BY	
东莞市箐国电子有限公司					
DRAWING NO.					