

ROHS COMPLIANT

Voltage Current Rating: 5 AMP.
 Dielectric Withstanding Voltage: 1000V AC
 Contact Resistance: 15 mΩ Max.
 Insulation Resistance: 1000MΩ Min.
 Temperature Range: -55°C to +85°C

PART NO.:

B04-0XX611AD-F4

CONTACT AREA:

015: 15PIN
 062: 62PIN

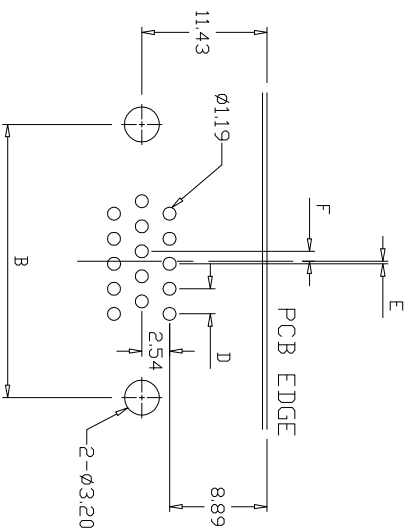
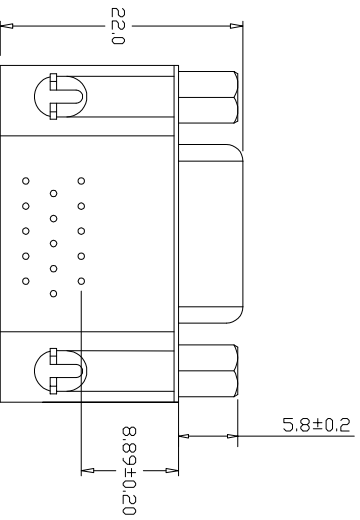
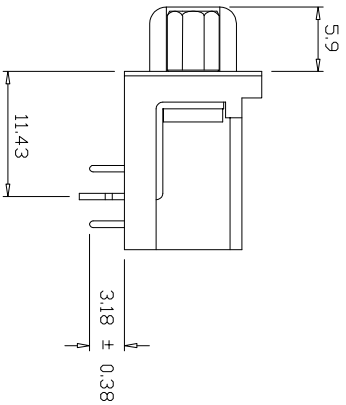
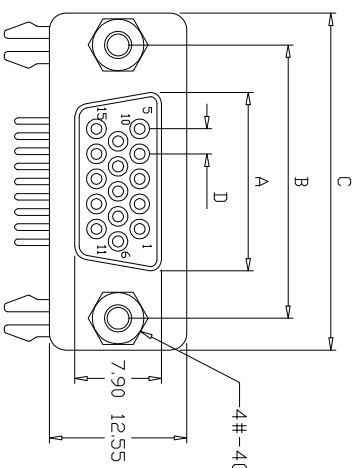

Neof. contact	Dim. A ±0.20	Dim. B ±0.25	Dim. C ±0.38	Dim. D	Dim. E	Dim. F
15 pin	16.33	24.99	30.80	2.29	0.25	0.89
26 pin	24.66	33.32	39.10	2.29	0.51	0.64
44 pin	38.38	47.04	53.00	2.29	0.51	0.64
62 pin	54.84	63.50	69.32	2.41	0.58	0.62

QUALITY SYMBOLS

□:
 ✖:

CRITICAL MAJOR

∇: ZERO DEFECT S.P.C

Tolerance

X. 50 ±0.50
 .X 30 ±0.30
 .XX 25 ±0.25

ITEM	DESC.	MATERIAL	REMARKS	PART REMARKS
5	RIVET	COPPER ALLOY	PLATING: NI	
4	BOARD LOOK	COPPER ALLOY	PLATING: NI	
3	HOUSING	PBT+30%GF	COLOR: BLACK	
2	SHELL	SPCC	PLATING: NI	
1	TERMINAL	COPPER ALLOY	CONTACT AREA: AU G/F SOLDER AREA: Sn UNDER-PLATING: NI	

NAME: HD-D-SUB FEMALE 90度DIP FOOTPRINT (客户用图)
 8.89mm

REV: A UNIT: mm
 SCALE: N:1 DATE: 2015/01/14
 DRAWN BY: KING ZHOU
 CHECK BY: KING ZHOU
 APP BY: AL2-002

东莞市箐国电子有限公司

Dim. A ±0.20	Dim. B ±0.25	Dim. C ±0.38	Dim. D	Dim. E	Dim. F
15 pin	16.33	24.99	30.80	2.29	0.89
26 pin	24.66	33.32	39.10	2.29	0.64
44 pin	38.38	47.04	53.00	2.29	0.64
62 pin	54.84	63.50	69.32	2.41	0.62

DATE	DESCRIPTION	APPROVER
2015/01/14	新版发行	King Zhou

DATE	DESCRIPTION	APPROVER
2015/01/14	新版发行	King Zhou