

High Power Contact Current Rating:  
 10.20 or 40AMPS  
 High Power Contact Resistance:  
 2.7 Milliohms Max.  
 Dielectric Withstanding Voltage:  
 1000V AC For 1 Minute  
 Insulation Resistance:5000MΩ Min.  
 Temperature Range:-25°C to +85°C

PART NO: B08-2W26114D-X1

Current Rating: \_\_\_\_\_  
 A = 10 AMPS Dim.A  $\phi$ 1.7 Dim.B  $\phi$ 2.2  
 B = 20 AMPS Dim.A  $\phi$ 2.8 Dim.B  $\phi$ 3.3  
 C = 30 AMPS Dim.A  $\phi$ 3.2 Dim.B  $\phi$ 3.7  
 D = 40 AMPS Dim.A  $\phi$ 3.7 Dim.B  $\phi$ 4.2

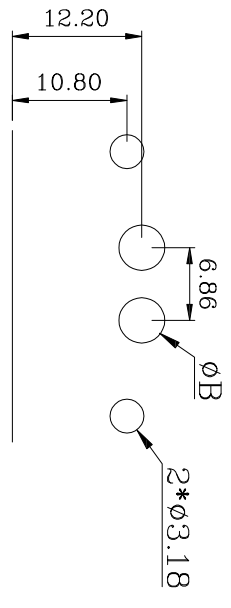
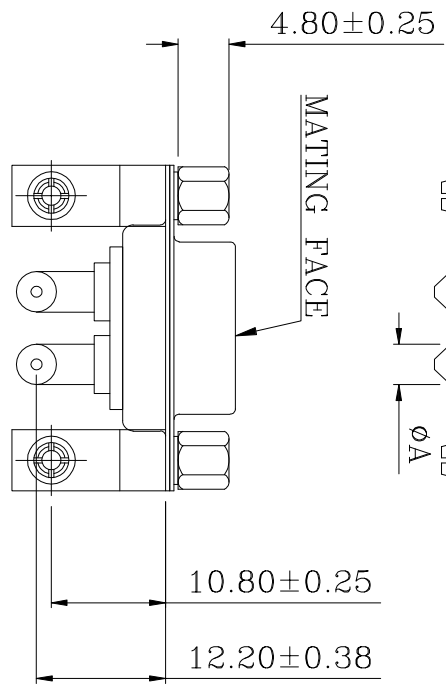

PCB LAYOUT

ITEM	DESC.	MATERIAL	REMARKS	PART REMARKS
6	JACKSCREWS	BRASS	PLATING: NI	
5	HOUSING	PBT+30%GF	COLOR: WHITE	
4	RIVETED INSERT	BRASS	PLATING: NI	
3	REAR SHELL	SPCC	PLATING: Sn	
2	FRONT SHELL	SPCC	PLATING: NI	
1	TERMINAL	BRASS	TERMINAL FINISH: FULL GOLD FINISHED 2u"	

QUALITY SYMBOLS

□ : CRITICAL  
 ✕ : MAJOR  
 ▽ : ZERO DEFECT S.P.C

Tolerance

x. ±0.50  
 x ±0.30  
 .xx ±0.25

NAME: 2W2 Female R/A Type With Bracket+Nut  
 PART NO. B08-2W26114D-X1

REV: A UNIT: mm  
 SCALE: N:1 DATE: 2012/11/19  
 DRAW BY: KING ZHOU  
 CHK BY: APP BY: JINGLI  
 DRAWING NO. B08-002

东莞市箐国电子有限公司

8	7	6	5	4	3	2	1
A	DATE	DESCRIPTION	APPROVER	ZERO DEFECT S.P.C			
	2012/11/19	NEW ISSUE	JINGLI				
B							
C							
D							
E							
F							