

Voltage Current Rating: 1.5 AMP.
 Dielectric Withstanding Voltage: 500V AC
 Insulation Resistance: 1000MΩ Min.
 Temperature Range: -25°C to +85°C

3	SHELL	COPPER ALLOY	PAIATING: NI	
2	HOUSING	PBT+30%GF	COLOR: BLACK	
1	TERMINAL	COPPER ALLOY	CONTACT AREA: G/F	
ITEM	DESC.	MATERIAL	REMARKS	PART REMARKS

QUALITY SYMBOLS

□ : CRITICAL

☒ : MAJOR

▽ : ZERO DEFECT

Tolerance

X. ±0.50

.X ±0.30

.XX ±0.25

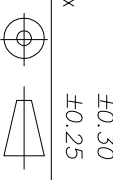

NAME: SM-10P Female V/T DIP Type

REV: A

SCALE: N:1

DATE: 2019/11/06

DRW BY: JINGLI

CHK BY: KING ZHOU

PART NO. B01-010813AN-01

APP BY: DRAMING NO. B05-026

东莞市箐围电子有限公司

DATE	DESCRIPTION	APPROVER
2019/11/06	NEW ISSUE	JINGLI

QUALITY SYMBOLS	CRITICAL	MAJOR	ZERO DEFECT	S.P.C
-----------------	----------	-------	-------------	-------

QUALITY SYMBOLS	CRITICAL	MAJOR	ZERO DEFECT	S.P.C
-----------------	----------	-------	-------------	-------

QUALITY SYMBOLS	CRITICAL	MAJOR	ZERO DEFECT	S.P.C
-----------------	----------	-------	-------------	-------

QUALITY SYMBOLS	CRITICAL	MAJOR	ZERO DEFECT	S.P.C
-----------------	----------	-------	-------------	-------

QUALITY SYMBOLS	CRITICAL	MAJOR	ZERO DEFECT	S.P.C
-----------------	----------	-------	-------------	-------

QUALITY SYMBOLS	CRITICAL	MAJOR	ZERO DEFECT	S.P.C
-----------------	----------	-------	-------------	-------

QUALITY SYMBOLS	CRITICAL	MAJOR	ZERO DEFECT	S.P.C
-----------------	----------	-------	-------------	-------

QUALITY SYMBOLS	CRITICAL	MAJOR	ZERO DEFECT	S.P.C
-----------------	----------	-------	-------------	-------

QUALITY SYMBOLS	CRITICAL	MAJOR	ZERO DEFECT	S.P.C
-----------------	----------	-------	-------------	-------

QUALITY SYMBOLS	CRITICAL	MAJOR	ZERO DEFECT	S.P.C
-----------------	----------	-------	-------------	-------

QUALITY SYMBOLS	CRITICAL	MAJOR	ZERO DEFECT	S.P.C
-----------------	----------	-------	-------------	-------