

REVISIONS			
REV	ICN	DESCRIPTION	DATE APPROVED
C		PROPOSAL DRAWING	21/FEB/06 YK
D		ADDED SIGNAL CHANNELS	03/MAR/06 YK
E		ADDED 0 KEY OPTION	03/APR/06 YK
F		ADDED NO SCREW OPTION	03/JUL/06 YK
G		UPDATED FOOTPRINT TO LATEST SPEC	07/NOV/06 YK
H		NEW EMC GASKET	03/DEC/06 YK
J		MATING HEIGHT ADDED	01/JAN/07 ZLJ
K		REC. FACE PLATE TO LOCATING POST DIST. ADDED	01/MAR/07 ZLJ
L		REC. FRONT FACE TO LOCATING POST DIST. ADDED	03/APR/07 ZLJ

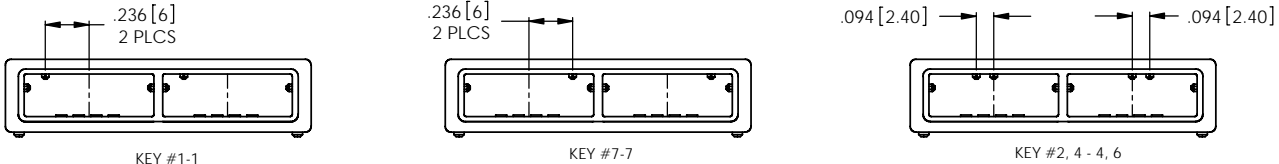

KEY #1-1 KEY #7-7 KEY #2, 4 - 4, 6

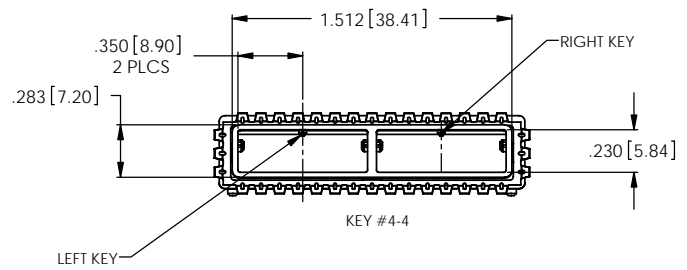

KEY #4-4

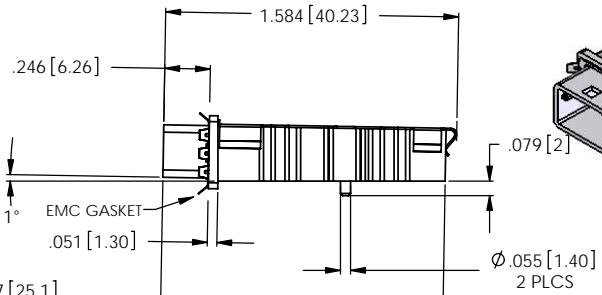

EMC GASKET

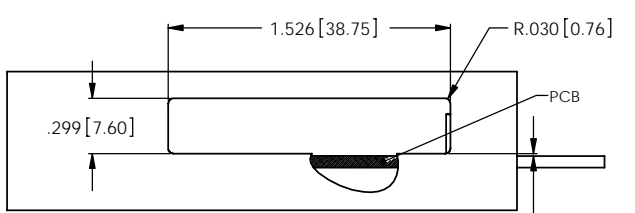
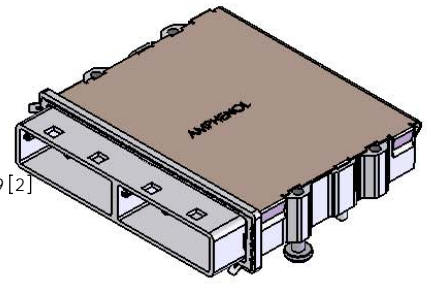

RECOMMENDED PANEL CUT-OUT

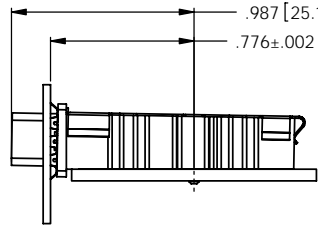

RECOMMENDED FACE PLATE TO LOCATING POST DISTANCE

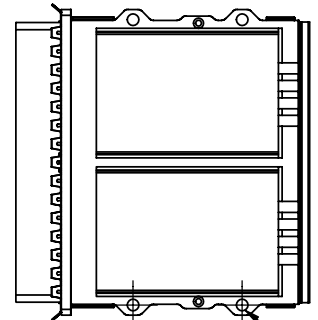

VIEW F M2 X 0,4 4 PLCS

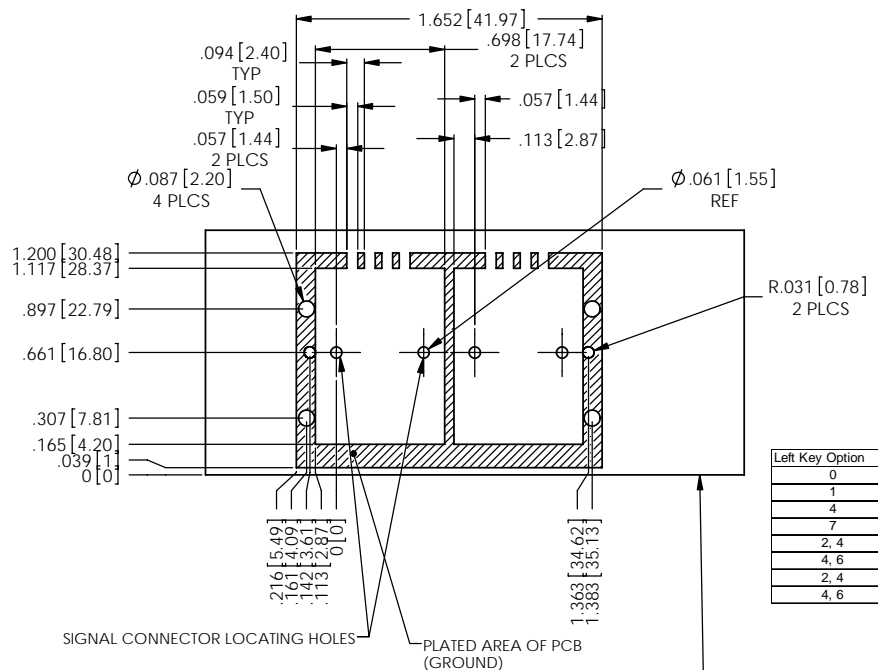

RECOMMENDED PCB LAYOUT

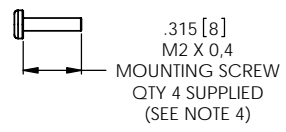

MOUNTING SCREW QTY 4 SUPPLIED (SEE NOTE 4)

Left Key Option	Right Key Option	Part Number	Description
0	0	FS1-S02-10E1	No Key
1	1	FS1-S02-11E1	SATA 'X' Cable
4	4	FS1-S02-14E1	SAS Universal Port
7	7	FS1-S02-17E1	SATA 'M' Cable
2, 4	2, 4	FS1-S02-1D22E1	SAS Out Port
4, 6	4, 6	FS1-S02-1D66E1	SAS In Port
2, 4	4, 6	FS1-S02-1D26E1	SAS Out/In Port
4, 6	2, 4	FS1-S02-1D62E1	SAS In/Out Port

- NOTES:
- 1) MATERIAL:
MAIN CAGE: ZINC DIECAST SHELL WITH 150 MICROINCHES OF NICKEL PLATING
EMC GASKET: STAINLESS STEEL
COVER: COPPER ALLOY WITH 150 MICROINCHES OF NICKEL PLATING
 - 2) ROHS COMPLIANT
 - 3) COMPLIES WITH SFF-8088 EXCEPT WHERE NOTED.
 - 4) NO MOUNTING SCREW OPTION: ADD "-N" SUFFIX TO PART NUMBER SHOWN. FOR EXAMPLE, FS1-S02-14E1-N FOR KEY 4, NO MOUNTING SCREWS.

DO NOT SCALE DRAWING

THIS DOCUMENT CONTAINS PROPRIETARY INFORMATION AND SUCH INFORMATION MAY NOT BE DISCLOSED TO OTHERS FOR ANY PURPOSE OR USED FOR MANUFACTURING PURPOSES WITHOUT PERMISSION FROM AMPHENOL CANADA CORP.

UNLESS OTHERWISE SPECIFIED DIMENSIONS ARE IN INCHES TOLERANCES ARE: DECIMALS ANGLES .XX ± .030 ± 2° XXX ± .015	APPROVALS	DATE	Amphenol Canada Corp.
	DRAWN YK	06/DEC/06	
MATERIAL AND FINISH	CHECKED YK	06/DEC/06	SFF, CAGE 1 X 2
	SA APPD		
ENG. REL. NO. EAR 123XX	DATE	REV	P-FS1-S02-1XE1 L
CODE IDENT. NO. 03554	DATE	REV	
	DATE	REV	1 OF 1