

- Current Rating: 1 Amp
- Insulation Resistance: 500MΩ/Min
- Withstanding Voltage: 500V AC/Min
- Contact Resistance: 35mΩ Max
- Temperature Range: -25°C ~ +85°C

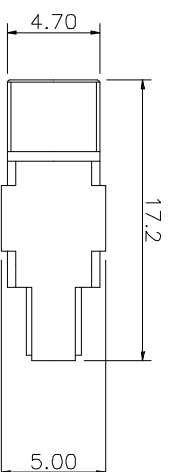
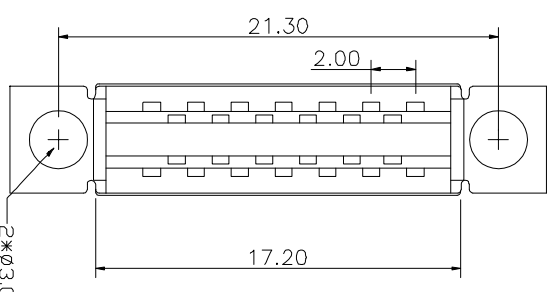
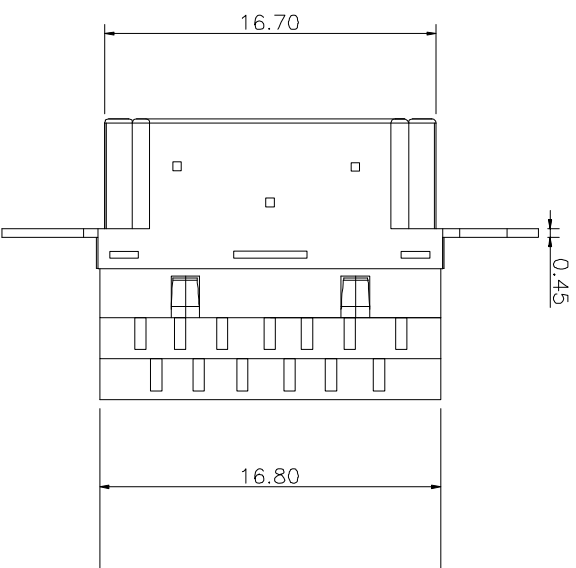
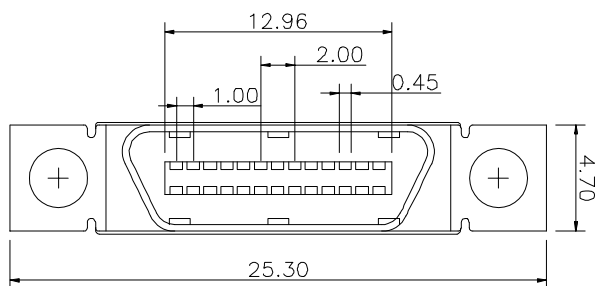

3	HOUSING	LCP+30%GF	COLOR:BEIGE	
2	SHELL	SPCC	PLATING:NI	
1	TERMINAL	COPPER ALLOY T=0.3mm	CONTACT AREA:G/F SOLDER AREA:Sn UNDER-PLATING:NI	
ITEM	DESC.	MATERIAL	REMARKS	PART REMARKS

QUALITY SYMBOLS

□ : MAJOR

⊠ : CRITICAL

∇ : ZERO DEFECT

Tolerance

x. ±0.50

.x ±0.30

.xx ±0.25

NAME:

REV: B

SCALE: N:1

CISCO 26P PITCH 1.0mm MALE SOLDER TYPE

UNIT: mm

DATE: 2014/09/23

PART NO.

DRW BY: JACK CHEN

CHK BY: KING ZHOU

B06-0263C1AN-02

APP BY: KING ZHOU

DRAWING NO. B06-012

修正电气参数

NEW ISSUE

JACK CHEN

JACK CHEN

APPROVER

DESCRIPTION

2021/04/14

2014/09/23

8

7

6

5

4

8

7

6

5

4

3

2

1

东莞市箐国电子有限公司